

# DNP21S Series

No1 Body: Cast-iron No2 Body: Aluminum / Charge pump



## ◆ Model number

**DNP21S 14 4.5 A 9 H 9 - R XXX**

1
2
3
4
5
6
7
8
9

- |  |  |   |  |
|--|--|---|--|
| <p>① Series number<br/>DNP21S series</p> <p>② No.1 Pump Size</p> <p>③ No.2 Pump Size</p> | <p>④ Position of outlet ports<br/>A : side ports</p> <p>⑤ Outlet port configuration<br/>9 : G screw thread</p> | <p>⑥ Mounting<br/>H : horizontal 2 bolts</p> <p>⑦ Shaft end<br/>9 : SAE Spline 10 teeth</p> | <p>⑧ Rotation viewing from shaft end<br/>R = clockwise</p> <p>⑨ Code number in 3 figures</p> |
|--|--|---|--|

## ◆ Specifications

	Size	Displacement		Rated pressure			Max. peak pressure			Speed min <sup>-1</sup>	
		cm <sup>3</sup>	in <sup>3</sup>	MPa	bar	psi	MPa	bar	psi	MIN.	MAX.
No.1 Pump	4.5	4.46	0.272	20.6	206	2987	24.5	245	3553	900	3000
	5	5.20	0.317								
	6	6.00	0.366								
	8	8.00	0.488								
	9	9.06	0.553								
	10.5	10.4	0.634								
	12	12.2	0.744								
No.2 Pump	14	14.1	0.860	3.9	39	566	9.8	98	1421		
	2.7	2.67	0.163								
	4.5	4.46	0.272								

## ◆ Typical assembly

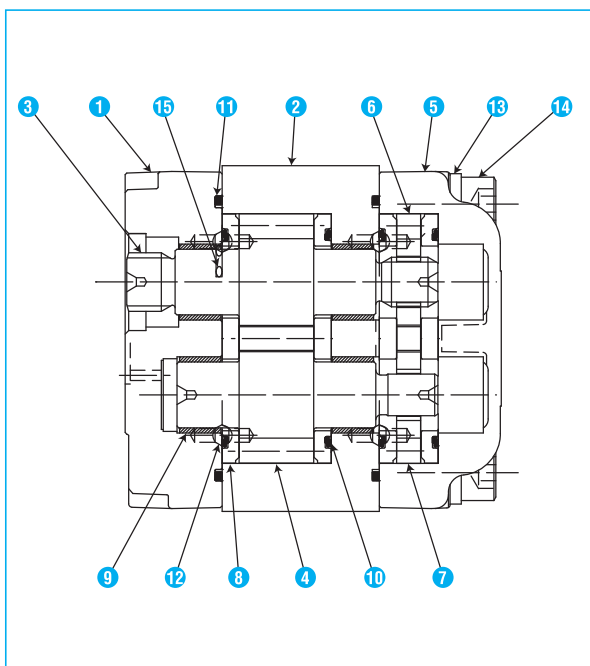

Item No.	Name	QTY	Material
①	Front cover	1	Cast iron
②	No.1 body	1	Cast iron
③	No.1 drive gear	1	Alloy steel
④	No.1 driven gear	1	Alloy steel
⑤	No.2 body	1	Aluminum alloy
⑥	No.2 drive gear	1	Special alloy steel
⑦	No.2 driven gear	1	Special alloy steel
⑧	Side plate	4	Special alloy steel
⑨	Bush	4	Special alloy steel
⑩	Gasket	4	Nitrile rubber
⑪	Gasket	2	Nitrile rubber
⑫	Steel ball	4	Alloy steel
⑬	Washer	4	Carbon steel
⑭	Bolt	4	Alloy steel
⑮	O-ring	1	Nitrile rubber

NOTES : "QTY" shows the amount per one

# DNP21S Series

No1 Body: Cast-iron No2 Body: Aluminum / Charge pump

## ◆ Outline dimensions

dimensions in mm

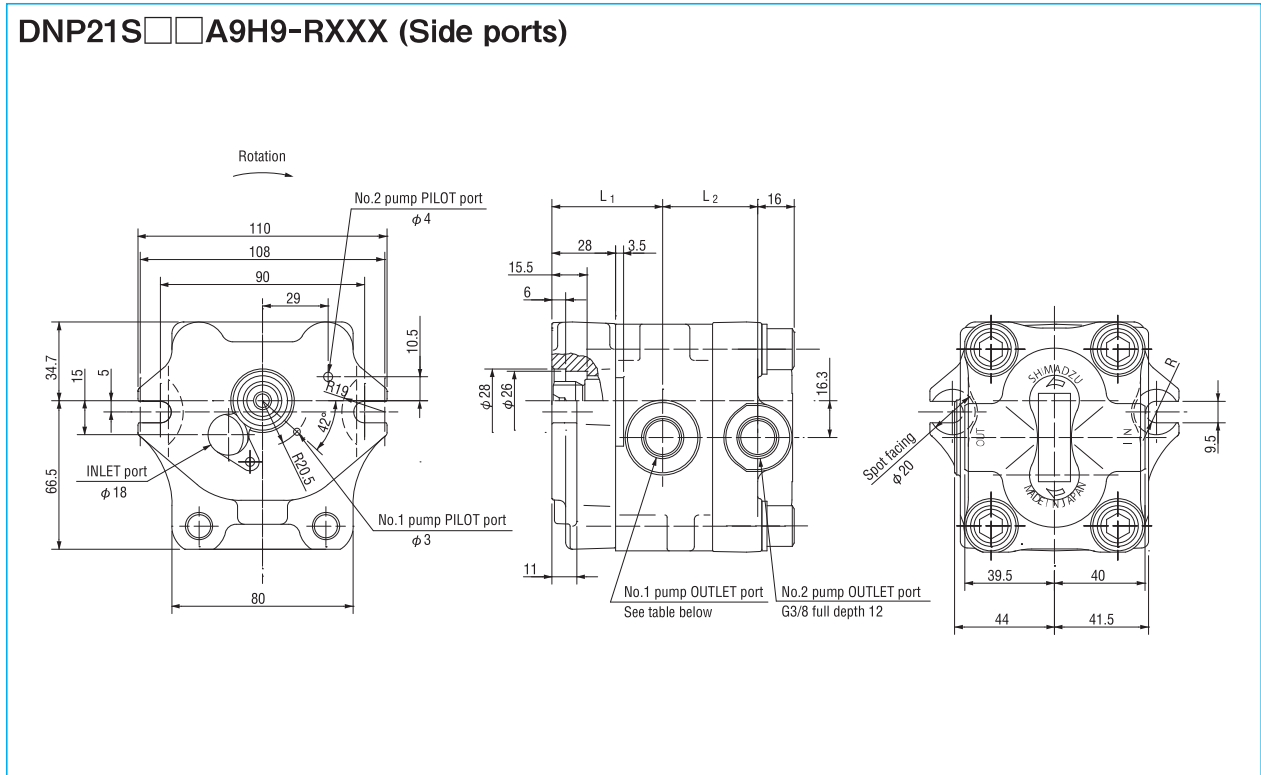

NOTE 1. Figure shown indicated clockwise rotation “R” viewing from shaft end.  
2. Unless otherwise specified, tolerance on dimension are  $\pm 1.0$  mm.

No.1 pump size	No.1 pump outlet port		L <sub>1</sub>	L <sub>2</sub>
	Thread	Depth		
4.5	G3/8	12	45.5	34.5
5				
6				
8				
9				
10.5	G1/2	16	50	42
12				
14				

## ● Shaft end

SAE Spline (Some dimensions are different form SAE standard.)	
SAE Spline 10 teeth	
	No. of teeth : 10
	D.P. : 16/32
	Pressure angle : 30°
	Over pin dia. : 20.263~ 20.193
	Pin dia. : φ3.048